



WARNING: DUE TO THE TYPICAL INSTALLATION REQUIREMENTS AND THE CAUSTIC CONTENT OF MANY CHEMICAL PRODUCTS, IT IS REQUIRED THAT ALL WATER SUPPLIES BE SHUT OFF BEFORE CONNECTING OR SERVICING THE SINK BOWL.

INSTALLATION / OPERATION

See the diagram on the following page for reference to the installation and calibrating steps below.

- (1) Mount the Sink Bowl to the wall, use the wall anchors and screws provided with the accessory kit.
- (2) Run flow tubing from the output fitting on the bottom end of the bowl body into the sink. The first 12" of the tubing run should be vertical to prevent liquids from backing up into the bowl.
- (3) Connect 3/8" OD tubing from the water source to the input fitting of the Sink Bowl and tighten carefully. The compression fitting can be removed for direct hard-plumbing with a 3/8" NPT connection, or can be substituted by a barb fitting or garden hose adapter.

IMPORTANT NOTES: Incoming water pressure must be 25 - 80 PSI. Do not use water temperature higher than 140°F. Use of 1/4" water supply line is not recommended.

- (4) Insert a detergent container into the Sink Bowl, ensuring the container presses down the paddle valve lever. The paddle valve is a safety feature that will shut off water spray into the bowl if the container is removed.
- (5) Rotate the water valve T-handle counter-clockwise (vertical) to turn on water flow. Water will spray up inside the container (to dissolve detergent) and will also flow into the junction fitting at the bowl bottom where it will mix with the dissolved detergent that exits the bowl. Turn the T-handle clockwise (horizontal) to shut off.

CALIBRATING DETERGENT CONCENTRATION

The concentration of dissolved detergent is adjusted by regulating flow to the spray jet with the needle valve. A special tool is provided for adjusting the needle valve — the tool is a 3" long brass tube with one end slotted for gripping the T-handle of the needle valve. Removing the metal cover from the Sink Bowl is not required.

- (6) Insert the slotted end of the tool through the access hole on the right side of the metal cover and close the needle valve by turning clockwise until it stops. Then turn counter-clockwise 3 full turns to adjust the needle valve to its mid-point (6 full turns is maximum). Turn the water valve "on" to verify detergent is dissolving.
- (7) Check the solution strength of the water/detergent mixture dispensed by the Sink Bowl. Adjust the needle valve as needed to achieve the desired mix (clockwise for less detergent, counter-clockwise for more detergent).

DISCLAIMER

Knight Inc. does not accept responsibility for the mishandling, misuse, or non-performance of the described items when used for purposes other than those specified in the instructions. For hazardous materials information consult label, MSDS, or Knight Inc.

WARRANTY

All Knight controls and pump systems are warranted against defects in material and workmanship for a period of ONE year. All electronic control boards have a TWO year warranty. Warranty applies only to the replacement or repair of such parts when returned to factory with a Knight Return Authorization (KRA) number, freight prepaid, and found to be defective upon factory authorized inspection. Bearings and pump seals or rubber and synthetic rubber parts such as "O" rings, diaphragms, squeeze tubing, and gaskets are considered expendable and are not covered under warranty. Warranty does not cover liability resulting from performance of this equipment nor the labor to replace this equipment. Product abuse or misuse voids warranty.

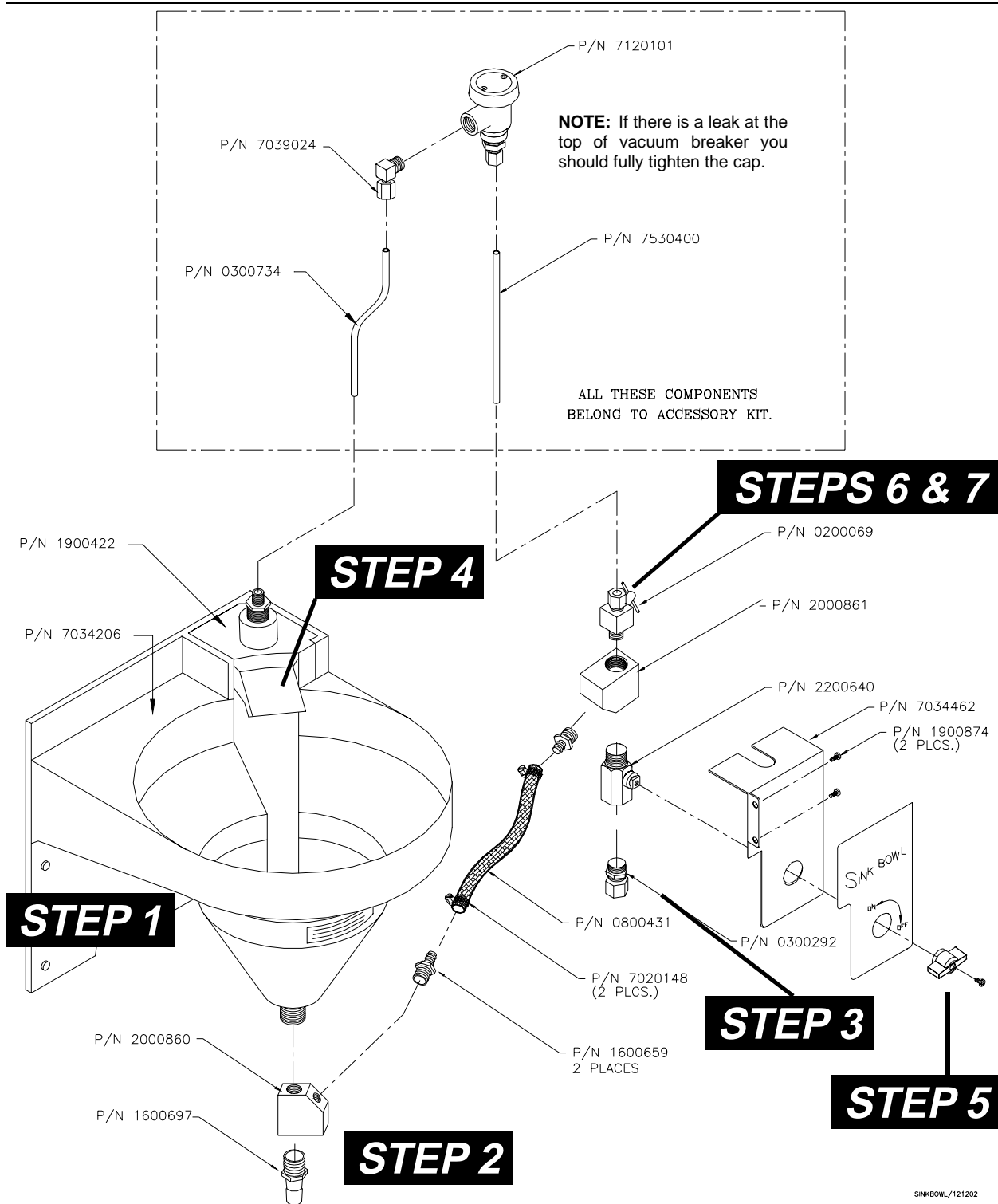

SINKBOWL/121202

KNIGHT INC. A Unit of IDEX Corporation

World Headquarters: 20531 Crescent Bay Drive, Lake Forest, CA 92630-8825 (USA) TEL: 949-595-4800, FAX: 949-595-4801, www.knightequip.com					
Atlanta Branch: 415 Gees Mill Business Court NE, Suite 200 Conyers, GA 30013 USA TEL: 770-760-8777 FAX: 770-761-0199	Toronto Branch: 2880 Argenta Road, Unit 6 Mississauga, Ontario L5N 7X8 Canada TEL: 905-542-2333 FAX: 905-542-1536	London Branch: #15 Brunel Centre Newton Road, Crawley West Sussex UK RH10 9TU TEL: 44-1293-615570 FAX: 44-1293-615585	Sydney Branch: Unit 28, 317-321 Woodpark Rd., Smithfield NSW Australia 2164 TEL: 61-29-725-2588 FAX: 61-29-725-2025	Amsterdam Branch: Marssteden 68 7547 TD Enschede The Netherlands TEL: 31-53-428-58-00 FAX: 31-53-428-58-09	Spain Branch: Port Ginesta, Local 210 08860 Sitges Barcelona Spain TEL: 34-936-342-130 FAX: 34-936-643-477